

MICROFLUSH® MODEL LF-210® TRIMLINE ROUND

GENERAL INFORMATION

The installation of the Microflush® marine head is similar to a conventional toilet and is suitable for replacing either standard fixtures or for use in new boat construction. The following are general installation requirements.

AIR SUPPLY - An air line from a compressed air source must be supplied. An air pressure regulator must be installed at the air tank to provide a constant pressure 60 PSI at the toilet. Sizing of compressors and air lines is shown on the Compressor sizing chart. An Air Connecting Kit, P/N 93086, is provided and contains fittings, shut-off cock and 72" of tubing to connect toilet to main air line with 1/4" MPT fitting. Optional Air Connecting Kits are available (see Air System Accessories).

WATER SUPPLY - Water is to be supplied to the toilet by a standard 1/2" water line with a minimum of 20 PSI and a maximum of 50 PSI and a constant pressure with a variation of no more than ± 3 PSI. Higher water pressure can prevent toilets from flushing. If higher pressures are anticipated, install a pressure reducing valve in the water line. Ideal pressure is 35 PSI.

Water supply should be located 9" from centerline of toilet and 3" from floor. Water supply should be 1/2" flexible line from angle stop to fitting on toilet which is 1/2" NPS slip joint nut (1/2" lavatory supply) (see Rough-In Dimensions).

TOILET SEAT - Toilet seat post holes are on 5-1/2" centers. The seat is not provided with unit (see Toilet Accessories).

TOILET MOUNTING & CONNECTION - A wax ring with plastic insert (Kant Leak or No-Seep) is provided on bottom discharge units. Where the floor is uneven a second standard wax ring may be required. Toilet can be mounted to floor with 1/4" closet screws.

ROUGH-IN DIMENSIONS

(All Dimensions ± 0.5 ")

LF-210 Round - Downward Discharge

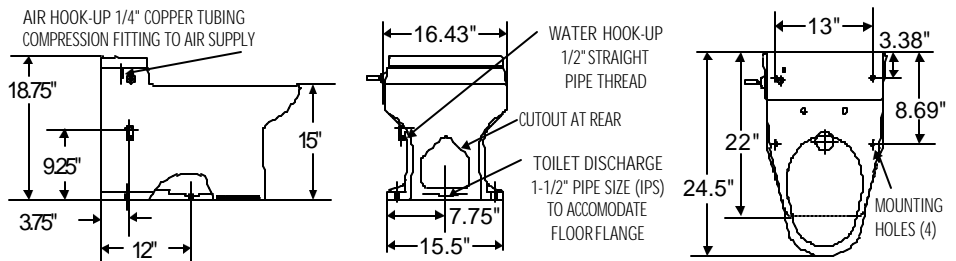

LF-210 Round - Rear Discharge

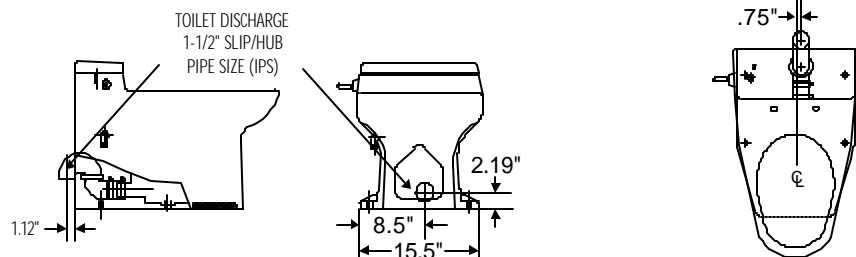

Remote Flush Rough-In

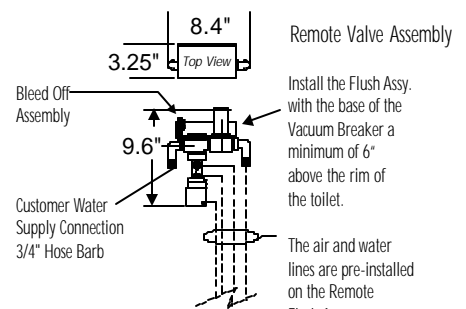
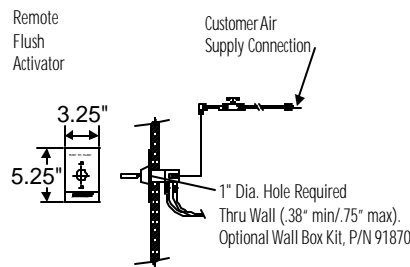

THE MAXIMUM WATER LINE DISTANCE BETWEEN THE TOILET AND THE REMOTE FLUSH ASSY IS EIGHT (8) FEET.

Grfs-210r-eps-ocr

MOUNTING BOLT CAPS - Mounting bolt caps are provided with models specified on reverse side.

VANDAL RESISTANT LID - For marine installations and where vandalism may be a concern, it is recommended the unit be ordered with a part No. 99073 vandal resistant lid. Available in white only.

SHIPPING INFORMATION -

Weight: 85 lbs.; Volume 6.9 cubic feet

WARRANTY - Limited one-year on all component parts. Detailed warranty available upon request.

CHANGES IN DESIGN - Continuing a policy of research and development, Microphor, Inc., reserves the right of price, product, or design change without notice of obligation.

TOILET RISER - Microflush® china toilets meet ADA height requirements when mounted on the HR-1 Toilet Riser, P/N 93503.



452 East Hill Road
Willits, CA 95490 USA
Phone: 707.459.5563
Toll Free: 800.358.8280

Fax: (707) 459-6617
E-mail: info@microphor.com
www.microphor.com
www.wabtec.com

Form: 636
Rev 5/24/00